

1. Scenarios with panel

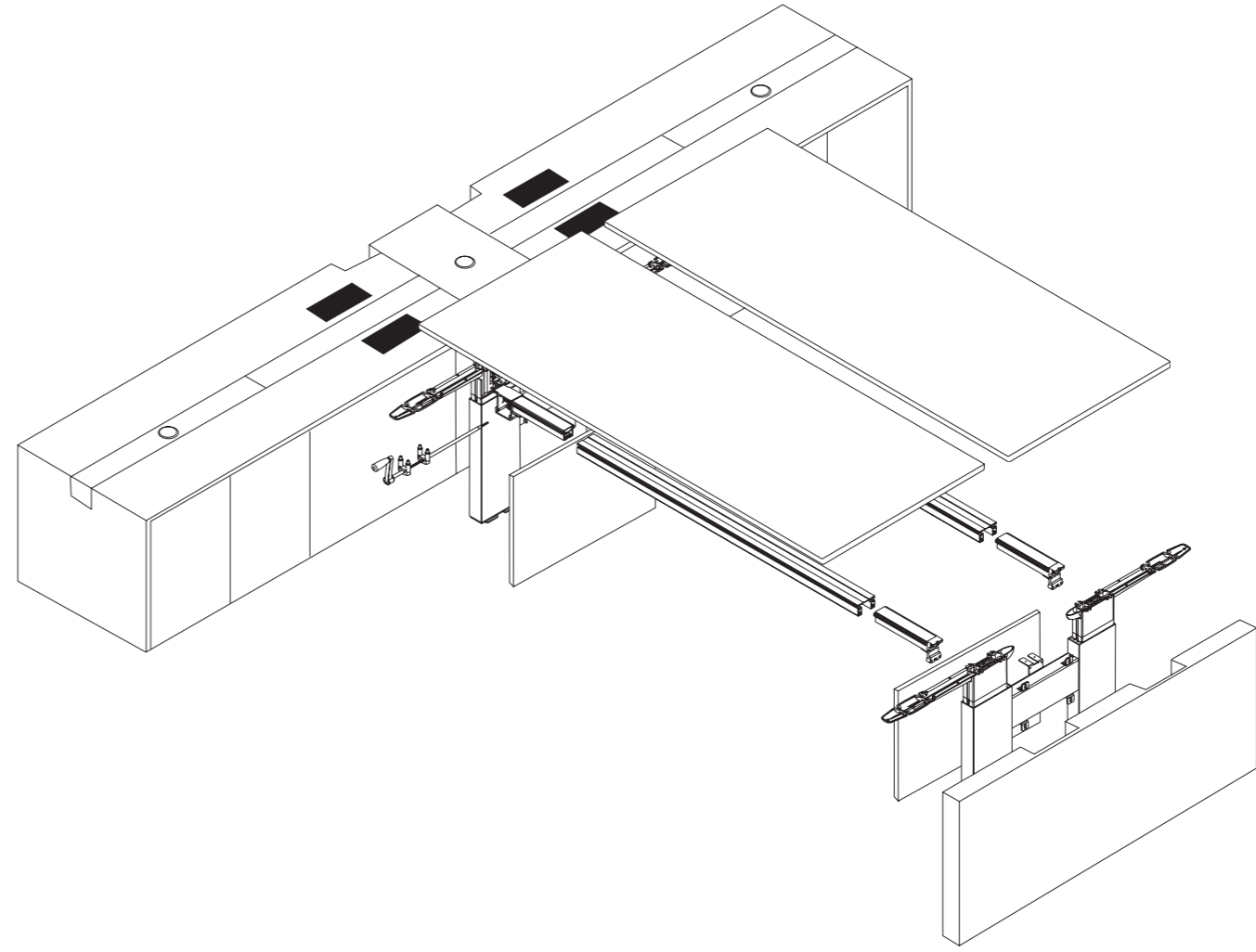

2. Scenarios with cabinet

SCENARIOS LEGS

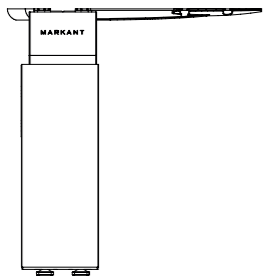

C-leg

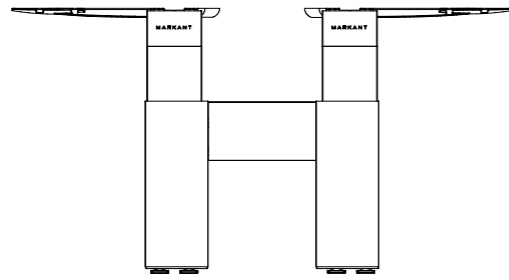

Combi C-leg

VERSION

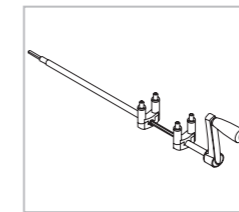

HV version -
via front crank

BEAM

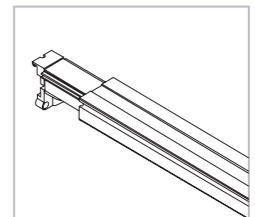

Aluminium Beam

INSTALLATION MANUAL

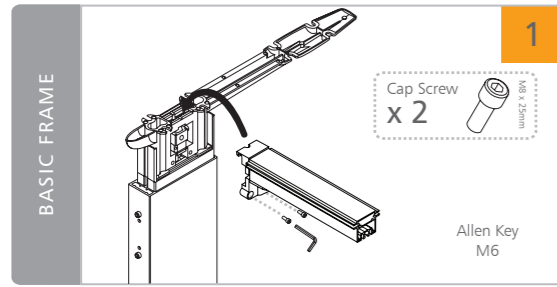

Mount connector to endlegs with cap screws.

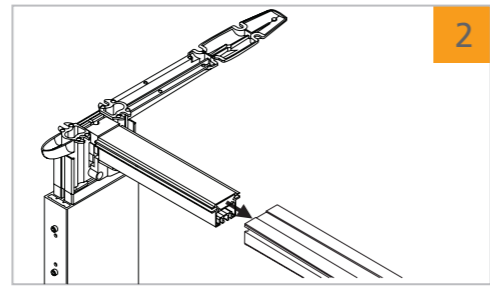

Slide connector into beam.

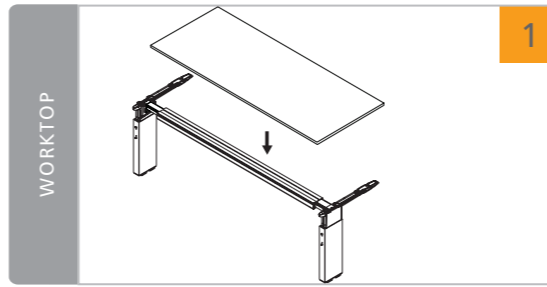

Place worktop on frame.

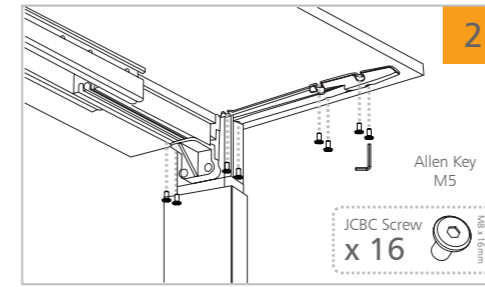

Bottom view - Attach worktop with JCBC screws from bottom of top support.

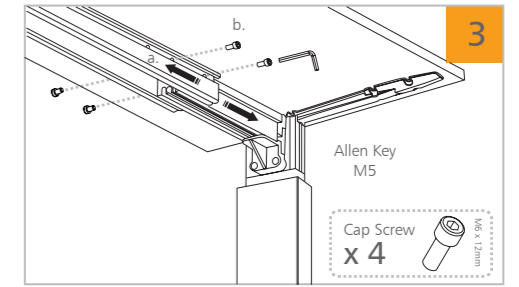

Bottom view - a. Adjust the length of the beam to fit with worktop, b. Fix cap screws into beam.

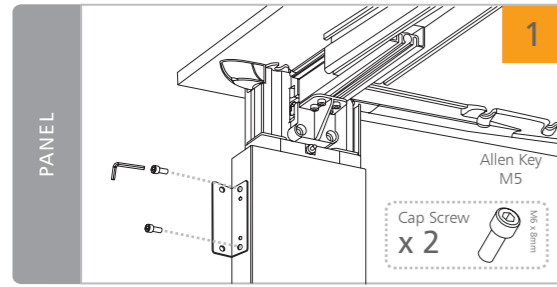

Bottom view - Attach connection plate at the side of the endleg.

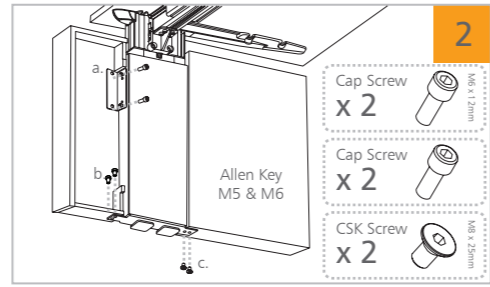

Bottom view - Attach endleg into panel - a. Fix cap screw at the connection plate, b. Fix cap screw at the bottom of the panel, c. Fix CSK screw at the bottom of the panel.

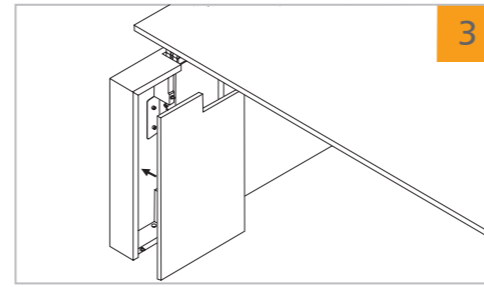

Attach the removable cover to close the panel.

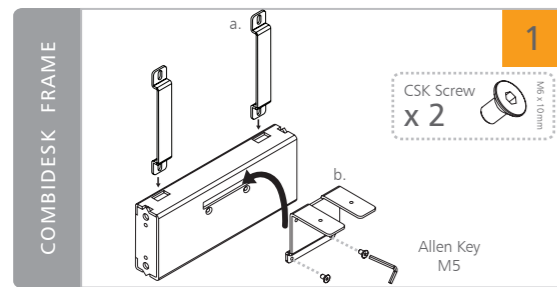

Attach part a and b to the leg connection plate.

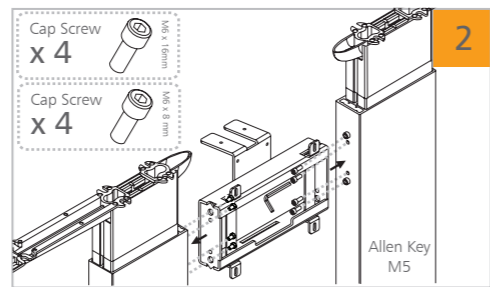

Attach connection plate to both end legs.

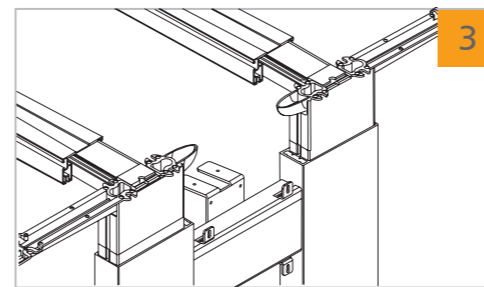

Attach beams and connectors to the combileg.

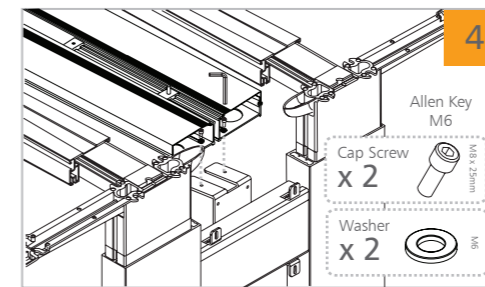

Attach cabletray to the Combileg.

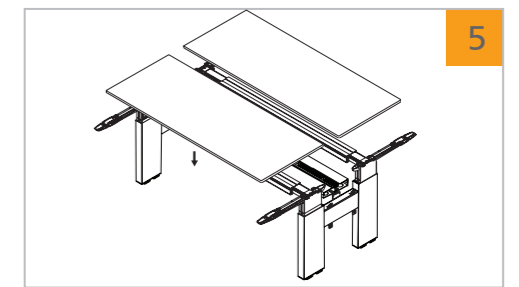

Fix worktop to endleg.

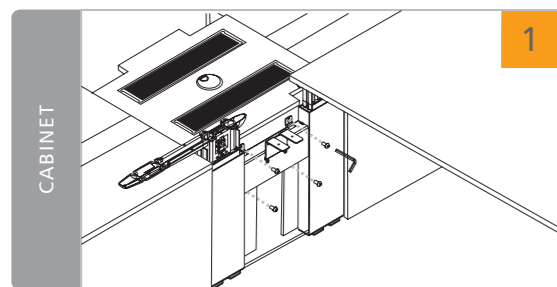

Attach Combileg to the cabinet.

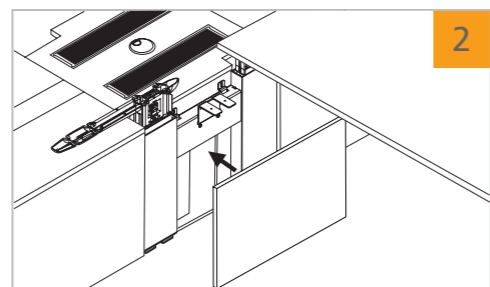

Mount removable cover to close the cabinet.

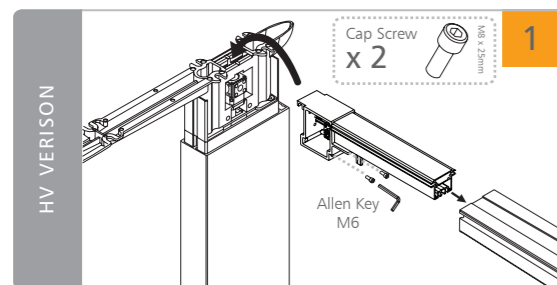

Mount connector to endlegs with cap screws. Slide connector into beam.

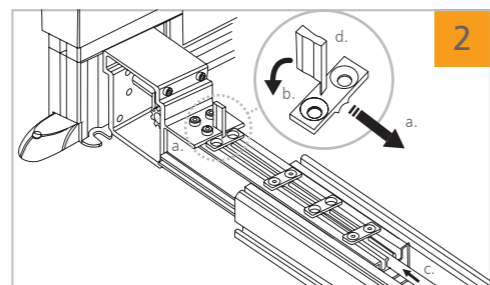

View up-side-down - a. Push plastic stopper (a) away from leg, b. Push down stopperhead (d) into centre gutter, c. Fit round axis over hexagon shaft inside connector, d. Pull stopper head out of gutter.

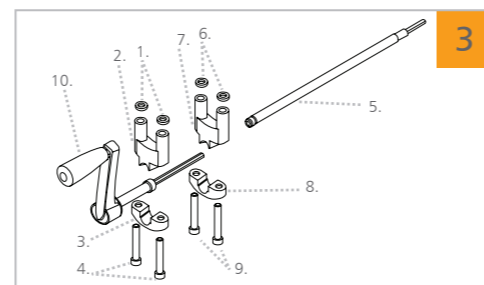

Assemble this 10 steps from 1 to 10.

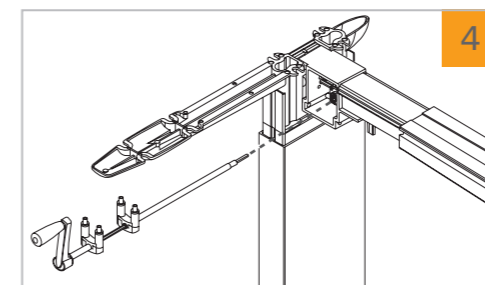

Insert crank handle into the round hole.